

CITY OF MURRAY CONTROL MONUMENT CARD

DESIGNATION: A6 2010 A
TYPE: 30" POURED CONCRETE MONUMENT W/ CITY DISK
DATE SET: JUNE 2010 QUAD: MURRAY, KY.
HORIZONTAL DATUM: NAD-83 (NSRS 2007)
VERTICAL DATUM: NAVD-88 (GPS) ZONE: KY. S 1602

NORTHING: 1752254.265 FT STATE: KENTUCKY
EASTING: 871385.905 FT COUNTY: CALLOWAY
ELEVATION: 557.13 FT (GPS)
LATITUDE: N 36°36'40.36010" LONGITUDE: W 088°22'13.32025"
SCALE: 1.000024410 CONVERGENCE: -1°35'20.95365"
PLANE AZI. TO AZI. MARK:

To Reach: From the intersection of Hudson Rd. _____
and Culver Rd., go north on Hudson Rd. about 300'
to the station on the left.

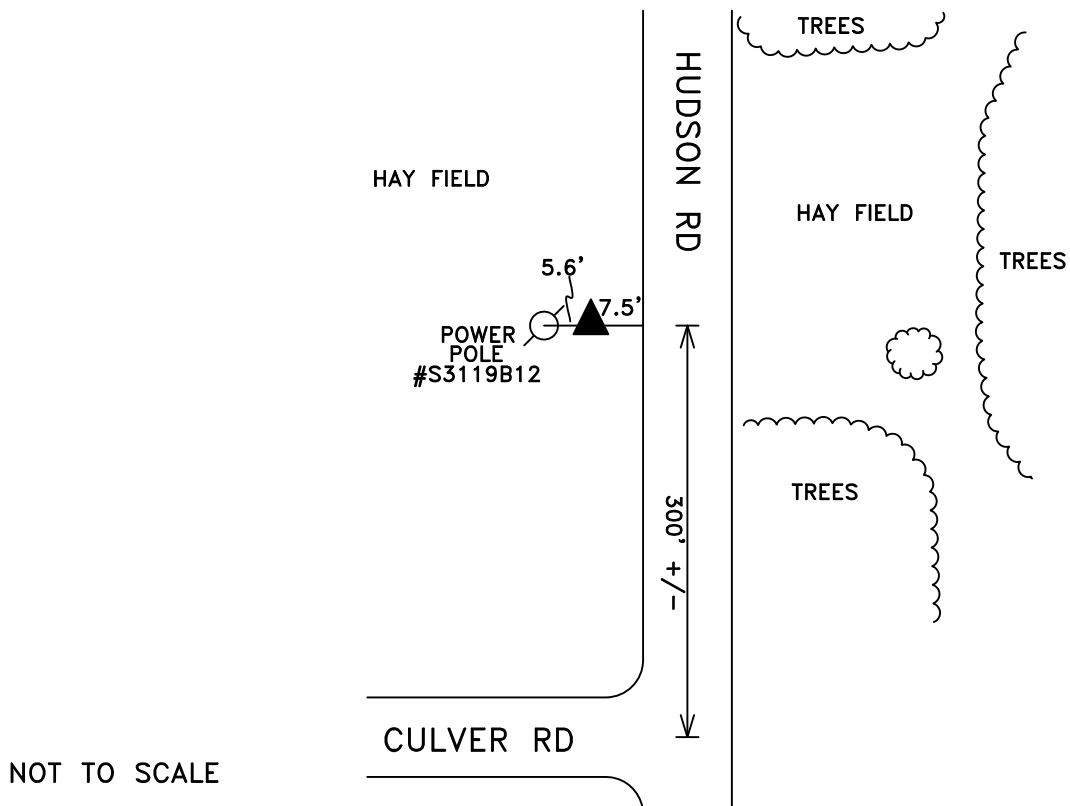

NOT TO SCALE



GRW Aerial Surveys, Inc.
801 Corporate Dr. Lexington Ky. 40503
(859)223-3999